

### Physical Specification

Nominal Voltage	6V
Nominal Capacity(20HR)	210Ah
Nominal Capacity(5HR)	175Ah
Length	260±2mm(10.24inches)
Width	180±2mm(7.09inches)
Container Height	248±2mm(9.76inches)
Total Height	279.5±2mm(11.00inches)
Dry Weight	Approx 18.0Kg(39.7lbs)
Wet Weight	Approx 25.5Kg(56.2lbs)
Acid	1.280±0.015g/cm <sup>3</sup> (25℃)
Standard Terminal	LPT
Container Material	PP

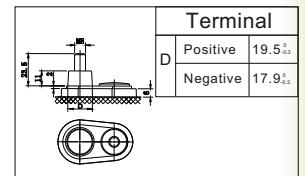
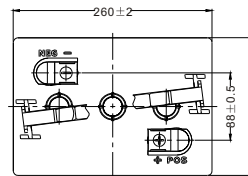
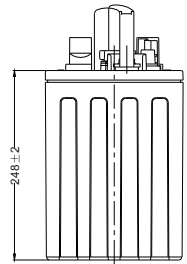
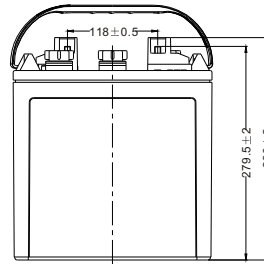

### Electrical Specification

Rated Capacity	20 hour rate(10.5A)	210Ah
	5 hour rate(35.0A)	175Ah
Reserve Capacity	25Amps	380min
	75Amps	105min

### Discharge Characteristics(25℃ , 77°F)

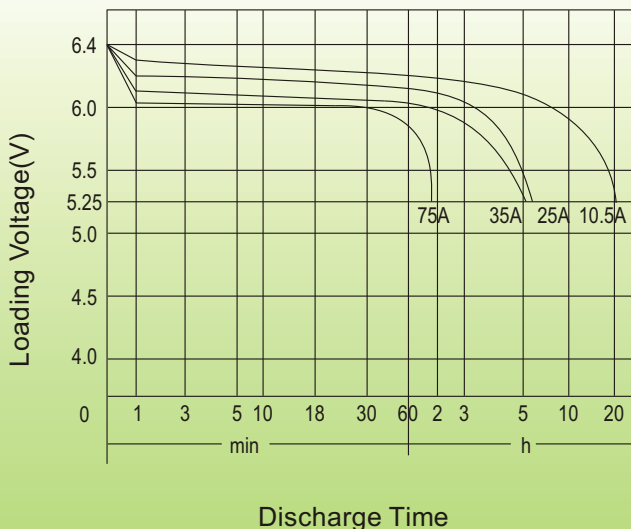

### Charge Method

#### Initial Charge:

- ① 0.1C<sub>20</sub> (A) charging 15h
- ② 0.05C<sub>20</sub> (A) charging 10h

The temperature of the battery should be below 50℃ during charging.

#### Supplement Charge:

- a) Charging at a constant voltage of 7.35~7.5V/cell and a limited current 0.25C<sub>20</sub> (A) until the electrolyte density up to 1.280g/cm<sup>3</sup> (30℃) and the current not change for 3 hours.
- b) Charge with constant current 0.1C<sub>20</sub> (A) until the voltage between 7.8~8.4V/cell, and voltage maintains for 3 hours and not change.

Two method optional